

# Electric system diagram

All the electric parts supplied as standard are indicated in    box.  
The purchaser is responsible for and needs to have the other cables and equipment.

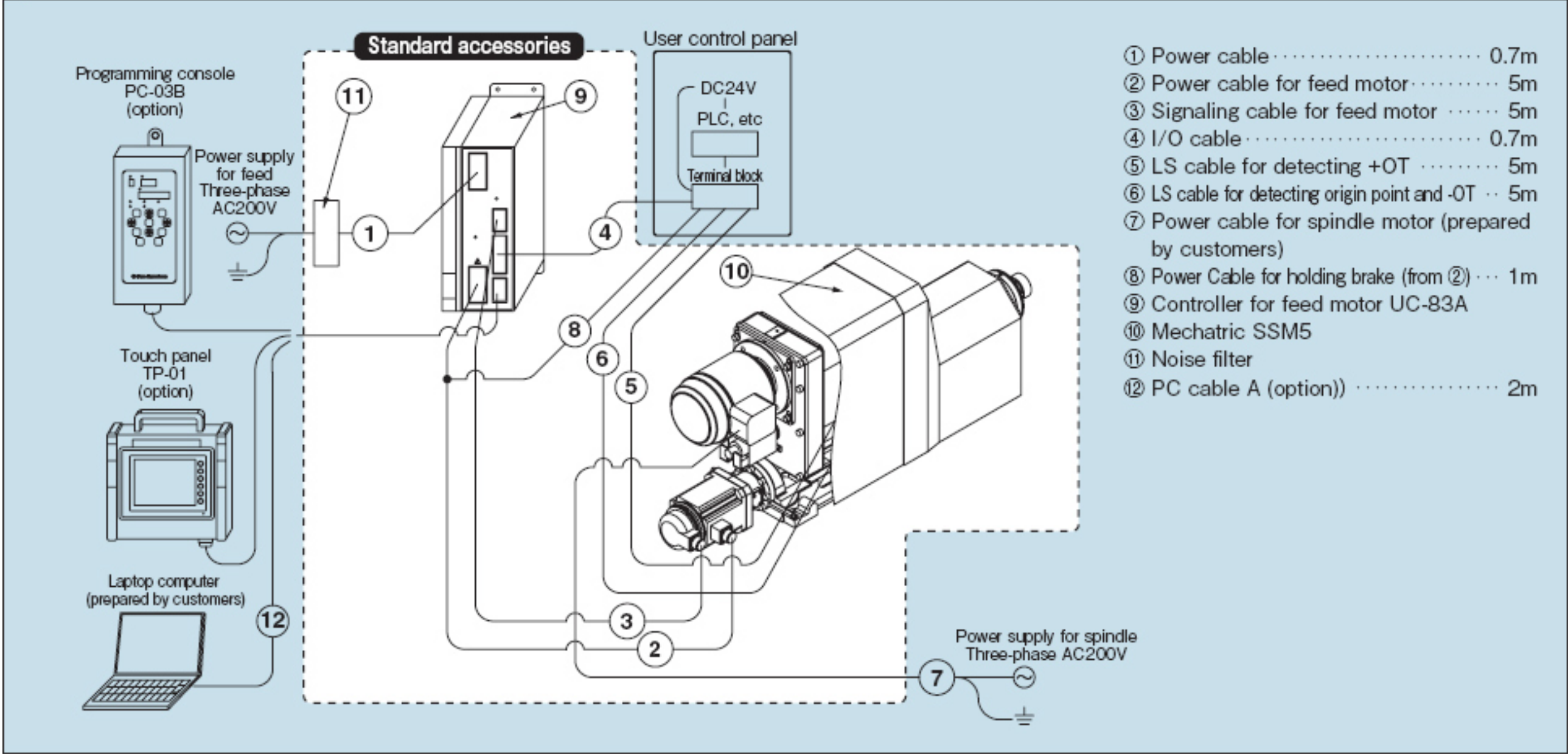

- Notes
1. The feed controller is standard accessories.
  2. The programming console and touch panel is optionally available. The attached cable is 3m long.
  3. Programming from a computer is possible using a ⑫ PC cable A. In such case, a dedicated computer monitoring software is required.  
Working environment: OS Windows 95/98/XP (The mode setting is necessary), Communication interface RS232C-port.

## Controller for feed motor UC-83A

### Dimensions(mm)

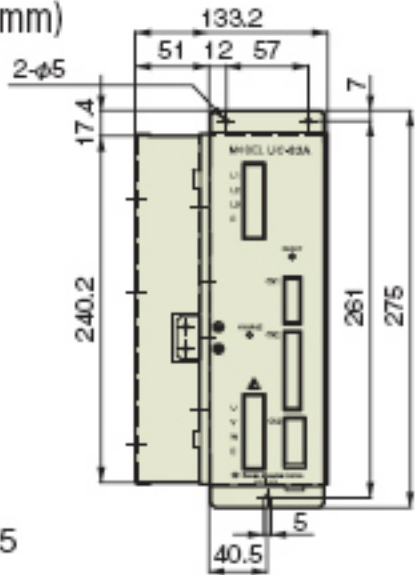

Dimensions (mm)/  
W133.2×D216×H275  
Weight/5.2kg

## Specification of signal

I/O	Signal	Contents
※1 Input	IN0	Emergency stop
	IN1	Manual coolant ON/OFF
	IN2	Power "ON"
	IN3	Machine zero return
	IN4	Single step
	IN5	Spindle alarm
	IN6	JOG+
	IN7	JOG-
	IN8	Forward side OT
	IN9	Backward side OT (Combine with origin LS)
	NC	No contact terminal
	IN10	Alarm clear
	IN11	EXT/MANUAL
	IN12	Manual spindle ON/OFF
	IN13	Program 1
	IN14	Program 2
	IN15	Program 4
	IN16	Program 8
	IN17	Program 10
	IN18	Program 20
	IN19	Program 40
	IN20	Program 80

I/O	Signal	Contents
※2 Output	OUT0	RDY
	OUT1	Cycle run
	OUT2	Program end
	OUT3	Origin
	OUT4	Spindle ON
	OUT5	Ready for single step
	OUT6	Coolant ON
	OUT7	Forward side ON
	OUT8	Alarm

※1 Voltage: DC24V, Electric current: 10mA  
※2 Voltage: DC24V, Electric current: 90mA